



# NATIONAL CENTRE OF EXCELLENCE IN FOOTBALL @ RAJRAHAT, KOLKATA

- ARCHITECTURAL DRAWINGS
- STRUCTURAL DRAWINGS

TENDER PACKAGE  
ARTIFICIAL TURF & DRAIN

22nd JULY, 2019

CLIENT :	ARCHITECT :
	

SR. NO.	DRAWINGS	DRAWING NO.
ARCHITECTURAL PACKAGE		
1	SITE PLAN-SURVEY	TD-A.0.01
2	TRAINING FIELD -1- ARTIFICIAL TURF	TD-A.0.03.B
3	SITE SECTIONS	TD-A.0.04A
4	SITE SECTIONS	TD-A.0.04B
5	SITE SECTIONS	TD-A.0.04C
6	SITE SECTIONS	TD-A.0.04D
STRUCTURAL PACKAGE		
7	STRUCTURAL DRAIN DETAILS	TD-S.4.03







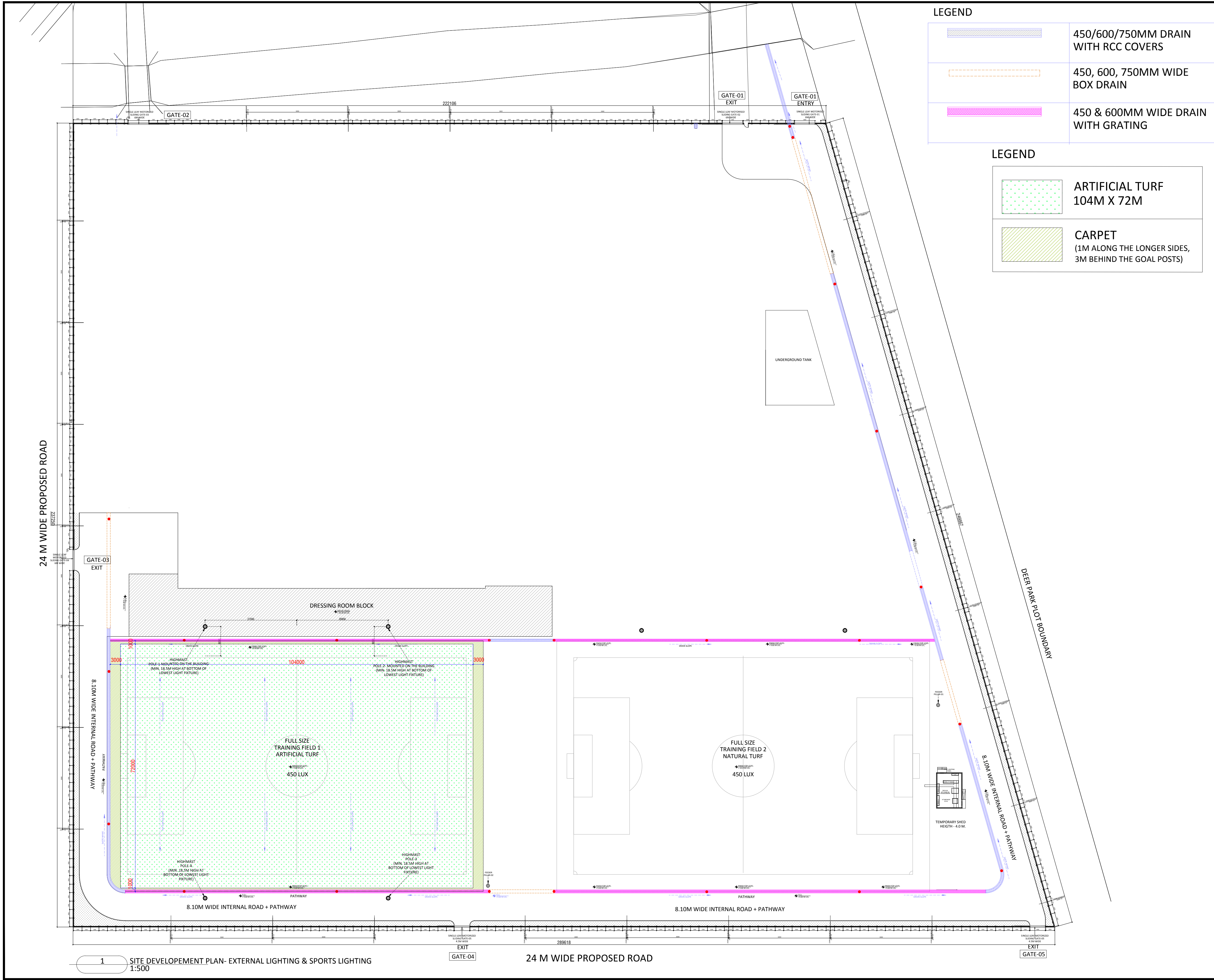

LEGEND	
	450/600/750MM DRAIN WITH RCC COVERS
	450, 600, 750MM WIDE BOX DRAIN
	450 & 600MM WIDE DRAIN WITH GRATING

LEGEND	
	ARTIFICIAL TURF 104M X 72M
	CARPET (1M ALONG THE LONGER SIDES, 3M BEHIND THE GOAL POSTS)

## TENDER DRAWING

- GENERAL NOTES**
1. ALL DIMENSIONS ARE IN MILLIMETERS AND LEVELS ARE IN METER UNLESS OTHERWISE SPECIFIED.
  2. ALL DIMENSIONS ARE TO BE CHECKED AND CO-RELATED WITH THE RELEVANT ARCHITECTURAL, STRUCTURAL AND SERVICES DRAWINGS AND ANY AMBIGUITY, DISCREPANCY OR OMISSION SHALL BE BROUGHT IN TO NOTICE OF ARCHITECT PRIOR TO COMMENCEMENT OF EXECUTION.
  3. DO NOT SCALE THE DRAWING, WRITTEN DIMENSION TO BE FOLLOWED.
  4. THIS DRAWING TO BE READ IN CONJUNCTION WITH THE RELEVANT SERVICES AND STRUCTURAL DRAWINGS.

REVISIONS		
REV	DESCRIPTION	DATE

## KEY PLAN

**CLIENT**

**ALL INDIA FOOTBALL FEDERATION**  
Football House, Sector 19, Phase 1,  
Dwarka, New Delhi: 110075  
Tel- 91-11-25308200/ 201  
Fax- 91-11-25308234/ 25308236  
Email- aiff@the-aiff.com

**ARCHITECT**

**collage design**  
ARCHITECTURE | INTERIORS | PMC  
COLLAGE DESIGN PVT. LTD  
300, Sai Sampanna, Station Rd  
Vikhroli East, Mumbai 400 083  
+91 22 2574 0842 / 43 / 44 / 45  
www.collagedesign.net

**STRUCTURAL CONSULTANT**

**SACPL**  
Shanghi and Associates  
Consultants Pvt.Ltd.  
7th Floor, Padmavati Heights,  
Shradhdhanand Road, Vile Parle (E),  
Mumbai - 400057.  
Tel - +91 22 2614 4832, Fax - +91  
22 2617 1804

**PROJECT**

NATIONAL CENTRE OF EXCELLENCE  
IN FOOTBALL @ RAJRAHAT, KOLKATA

**DRAWING TITLE**

TRAINING FIELD 1-  
ARTIFICIAL TURF

DWG. NO.		REV. NO.
TD-A.0.03.B		R0
PROJECT NO.	18-P245	
SCALE	1:500	
1 <sup>st</sup> ISSUED ON	17-07-2019	
APPROVED	RS	
CHECKED BY	BD	NORTH
DRAWN BY	BD	



TENDER DRAWING

GENERAL NOTES

1. ALL DIMENSIONS ARE IN MILLIMETERS AND LEVELS ARE IN METER UNLESS OTHERWISE SPECIFIED.
2. ALL DIMENSIONS ARE TO BE CHECKED AND CO-RELATED WITH THE RELEVANT ARCHITECTURAL, STRUCTURAL AND SERVICES DRAWINGS AND ANY AMBIGUITY, DISCREPANCY OR OMISSION SHALL BE BROUGHT IN TO NOTICE OF ARCHITECT PRIOR TO COMMENCEMENT OF EXECUTION.
3. DO NOT SCALE THE DRAWING, WRITTEN DIMENSION TO BE FOLLOWED.
4. THIS DRAWING TO BE READ IN CONJUNCTION WITH THE RELEVANT SERVICES AND STRUCTURAL DRAWINGS.

REVISIONS

REV	DESCRIPTION	DATE

KEY PLAN

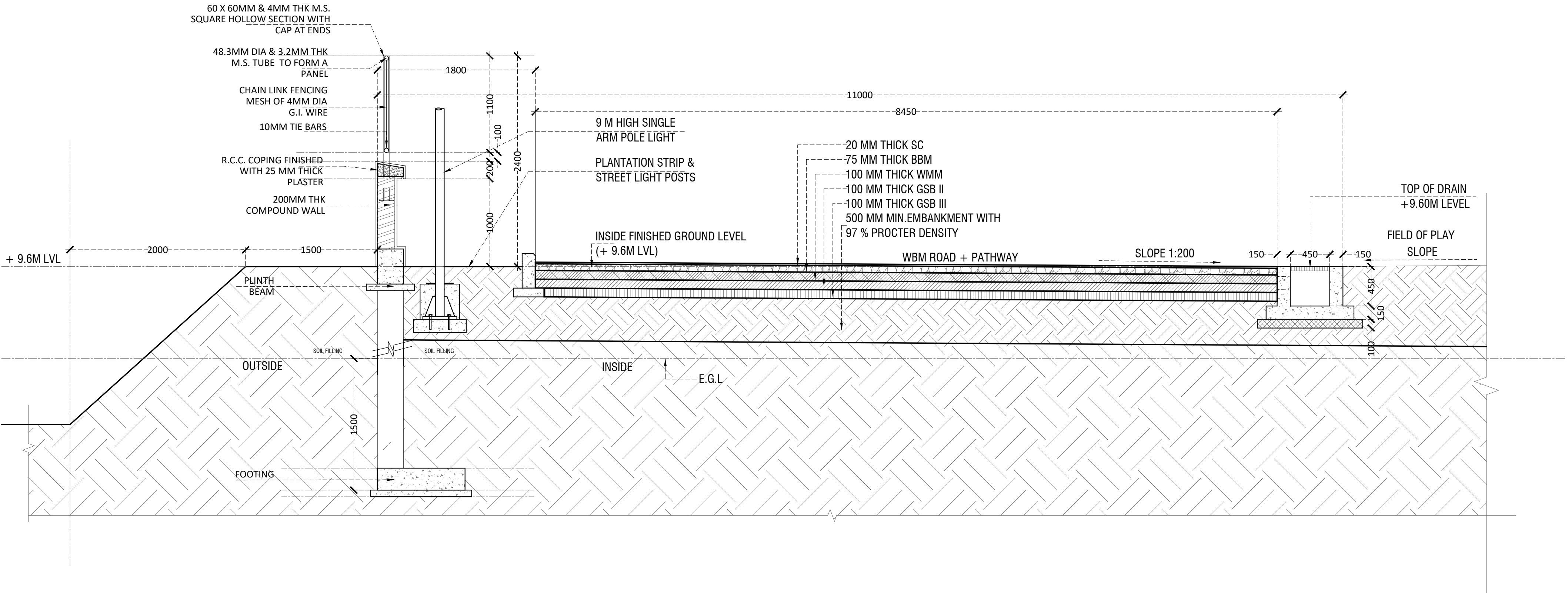

1 TYPICAL SECTION-1 (450MM WIDE DRAIN, MIN. 450MM DEPTH)  
1:30

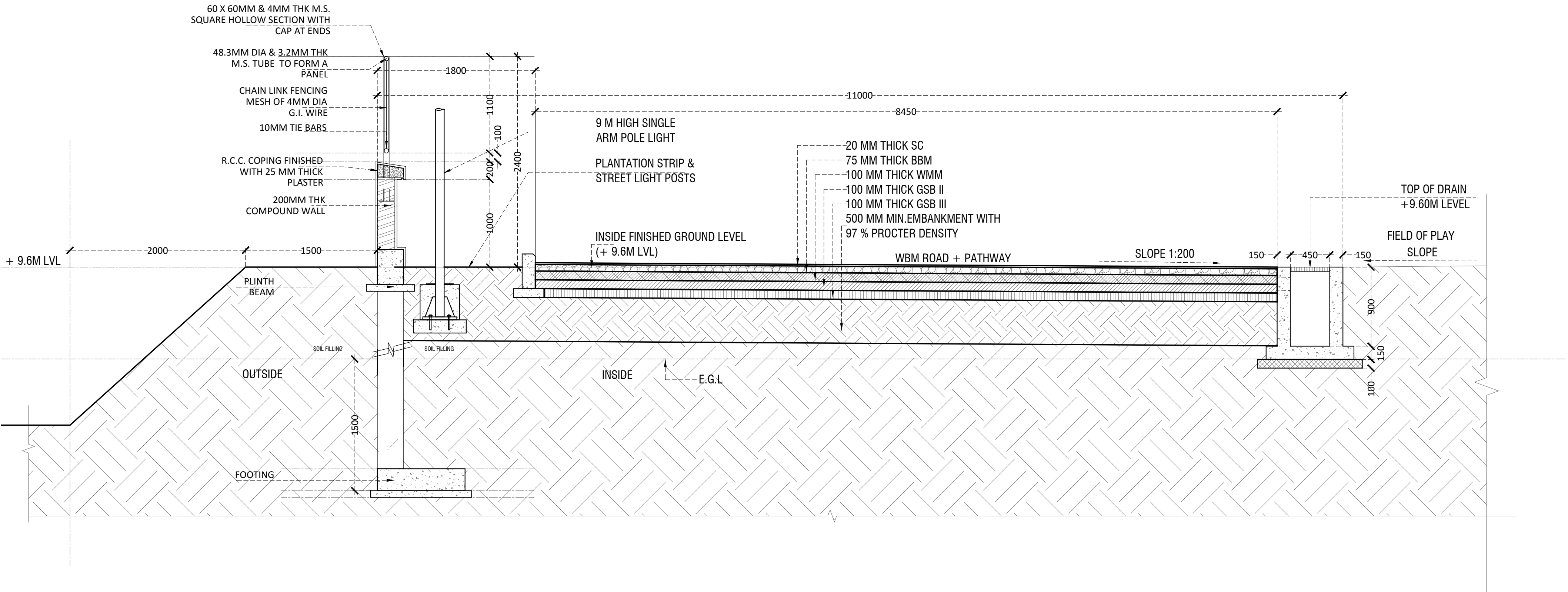

2 TYPICAL SECTION-2 (450MM WIDE DRAIN, MAX. 600MM DEPTH)  
1:30

CLIENT



ARCHITECT



STRUCTURAL CONSULTANT



PROJECT

NATIONAL CENTRE OF EXCELLENCE  
IN FOOTBALL @ RAJRAHAT, KOLKATA

DRAWING TITLE

TYPICAL ROAD & DRAIN SECTION  
SHEET-1

DWG. NO.	TD-A.0.04A	REV. NO.	R0
PROJECT NO.	18-P245	SCALE	1:30
1 <sup>ST</sup> ISSUED ON	19-02-2019	CHECKED BY	RS
APPROVED	BD	DRAWN BY	BD



TENDER DRAWING

GENERAL NOTES

1. ALL DIMENSIONS ARE IN MILLIMETERS AND LEVELS ARE IN METER UNLESS OTHERWISE SPECIFIED.
2. ALL DIMENSIONS ARE TO BE CHECKED AND CO-RELATED WITH THE RELEVANT ARCHITECTURAL, STRUCTURAL AND SERVICES DRAWINGS AND ANY AMBIGUITY, DISCREPANCY OR OMISSION SHALL BE BROUGHT IN TO NOTICE OF ARCHITECT PRIOR TO COMMENCEMENT OF EXECUTION.
3. DO NOT SCALE THE DRAWING, WRITTEN DIMENSION TO BE FOLLOWED.
4. THIS DRAWING TO BE READ IN CONJUNCTION WITH THE RELEVANT SERVICES AND STRUCTURAL DRAWINGS.

REVISIONS

REV	DESCRIPTION	DATE

KEY PLAN

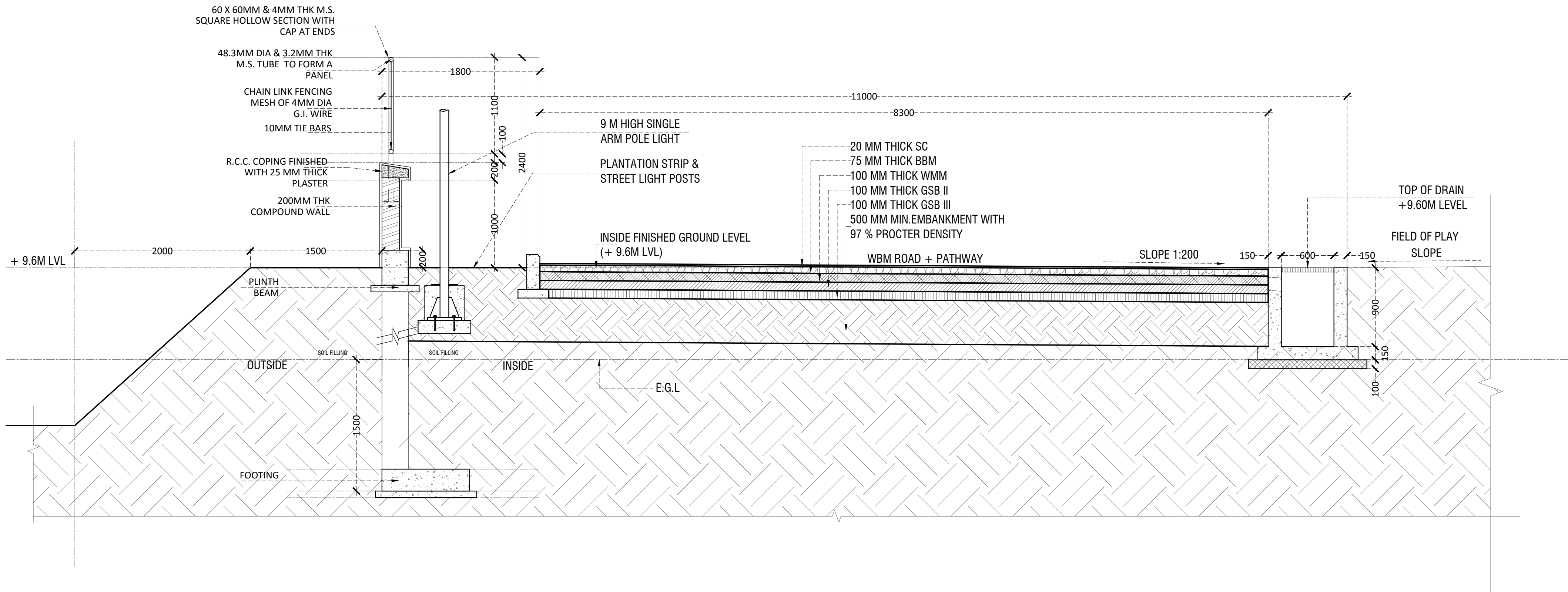

3 TYPICAL SECTION-3 (600MM WIDE DRAIN, MIN. 600MM DEPTH)  
1:30

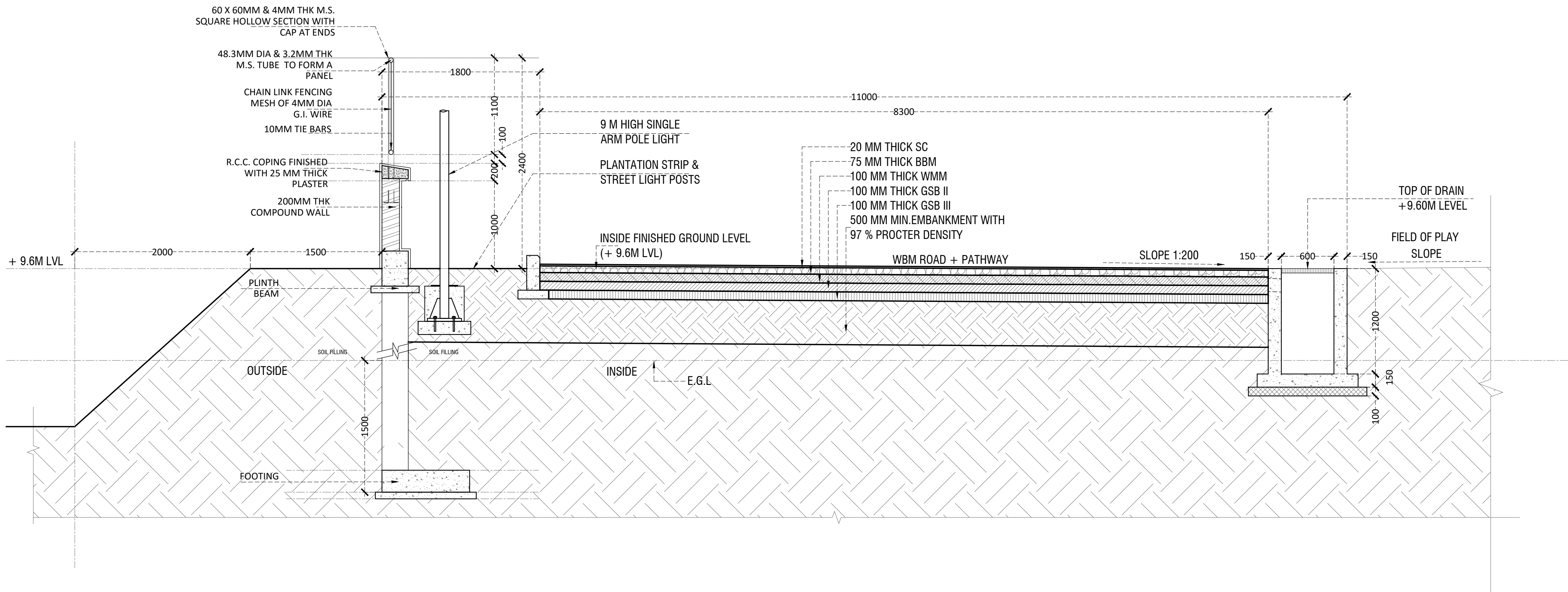

4 TYPICAL SECTION-4 (600MM WIDE DRAIN, MAX. 1200MM DEPTH)  
1:30

CLIENT



ARCHITECT



STRUCTURAL CONSULTANT



PROJECT

NATIONAL CENTRE OF EXCELLENCE  
IN FOOTBALL @ RAJRAHAT, KOLKATA

DRAWING TITLE

TYPICAL ROAD & DRAIN SECTION  
SHEET-2

DWG. NO.	REV. NO.
TD-A.0.04B	R0
PROJECT NO.	18-P245
SCALE	1:30
1 <sup>st</sup> ISSUED ON	19-02-2019
APPROVED	RS
CHECKED BY	
DRAWN BY	BD



TENDER DRAWING

GENERAL NOTES

1. ALL DIMENSIONS ARE IN MILLIMETERS AND LEVELS ARE IN METER UNLESS OTHERWISE SPECIFIED.
2. ALL DIMENSIONS ARE TO BE CHECKED AND CO-RELATED WITH THE RELEVANT ARCHITECTURAL, STRUCTURAL AND SERVICES DRAWINGS AND ANY AMBIGUITY, DISCREPANCY OR OMISSION SHALL BE BROUGHT IN TO NOTICE OF ARCHITECT PRIOR TO COMMENCEMENT OF EXECUTION.
3. DO NOT SCALE THE DRAWING, WRITTEN DIMENSION TO BE FOLLOWED.
4. THIS DRAWING TO BE READ IN CONJUNCTION WITH THE RELEVANT SERVICES AND STRUCTURAL DRAWINGS.

REVISIONS

REV	DESCRIPTION	DATE

KEY PLAN

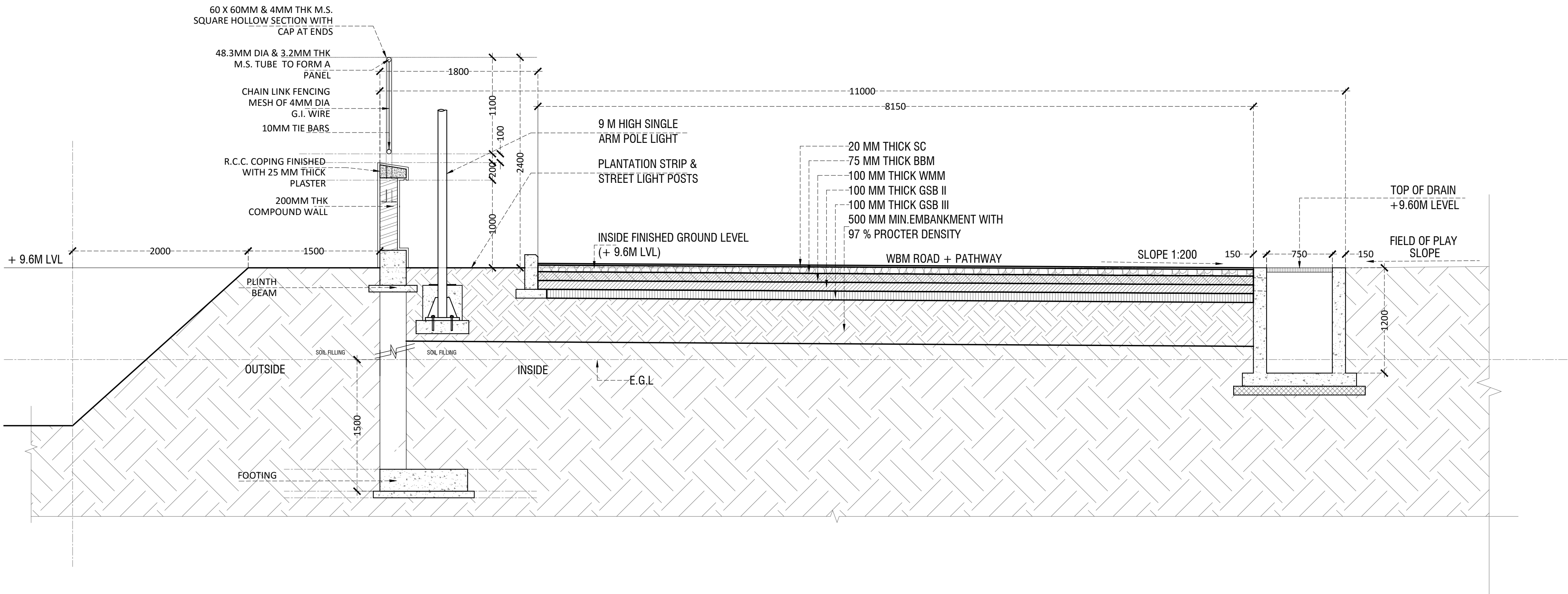

5 TYPICAL SECTION-5 (750MM WIDE DRAIN, MIN. 1200MM DEPTH)  
1:30

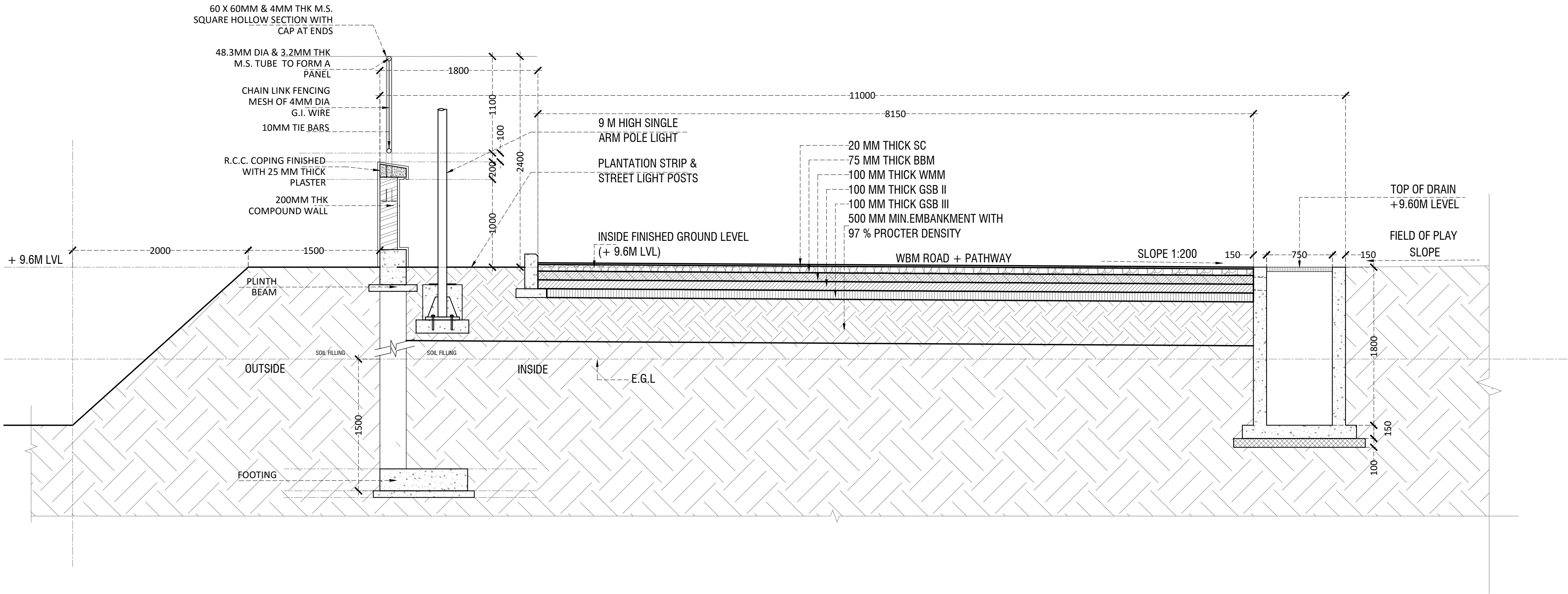

6 TYPICAL SECTION-6 (750MM WIDE DRAIN, MAX. 1800MM DEPTH)  
1:30

CLIENT



ARCHITECT



STRUCTURAL CONSULTANT



PROJECT

NATIONAL CENTRE OF EXCELLENCE  
IN FOOTBALL @ RAJRAHAT, KOLKATA

DRAWING TITLE

TYPICAL ROAD & DRAIN SECTION  
SHEET-3

DWG. NO.	TD-A.0.04C	REV. NO.	R0
PROJECT NO.	18-P245	SCALE	1:30
1 <sup>st</sup> ISSUED ON	19-02-2019	CHECKED BY	RS
APPROVED	BD	DRAWN BY	BD



## TENDER DRAWING

## GENERAL NOTES

1. ALL DIMENSIONS ARE IN MILLIMETERS AND LEVELS ARE IN METER UNLESS OTHERWISE SPECIFIED.
2. ALL DIMENSIONS ARE TO BE CHECKED AND CO-RELATED WITH THE RELEVANT ARCHITECTURAL, STRUCTURAL AND SERVICES DRAWINGS AND ANY AMBIGUITY, DISCREPANCY OR OMISSION SHALL BE BROUGHT IN TO NOTICE OF ARCHITECT PRIOR TO COMMENCEMENT OF EXECUTION.
3. DO NOT SCALE THE DRAWING, WRITTEN DIMENSION TO BE FOLLOWED.
4. THIS DRAWING TO BE READ IN CONJUNCTION WITH THE RELEVANT SERVICES AND STRUCTURAL DRAWINGS.

## REVISIONS

REV	DESCRIPTION	DATE

## KEY PLAN

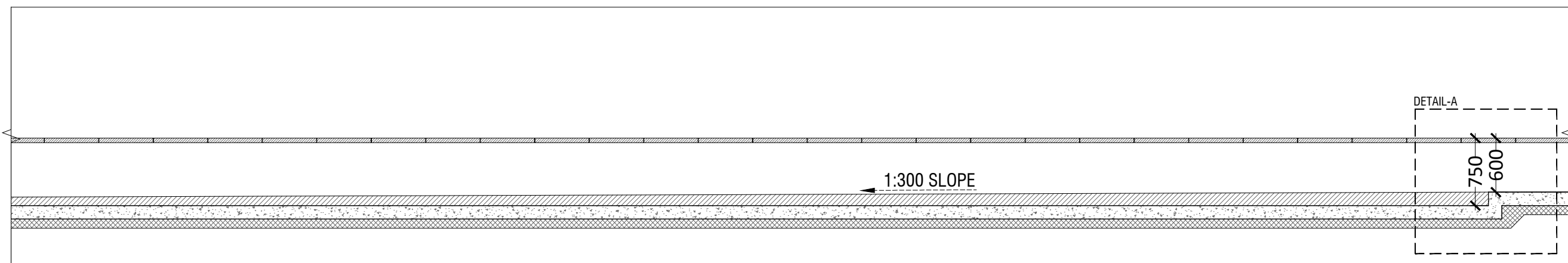
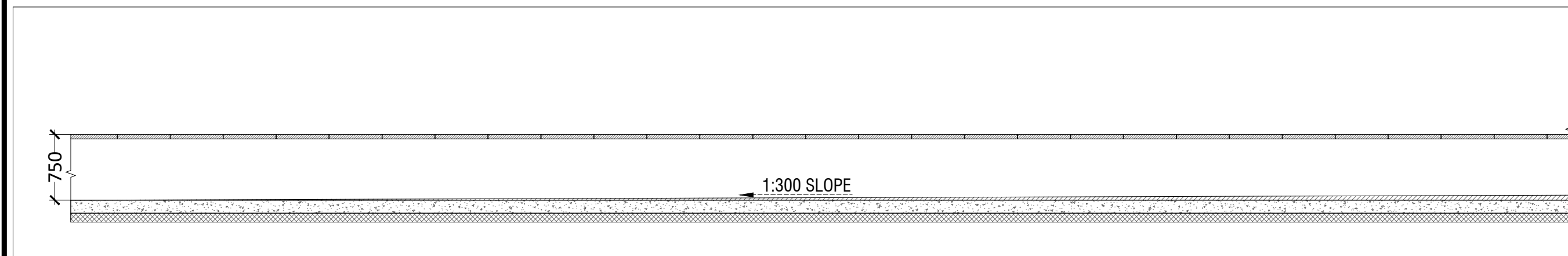
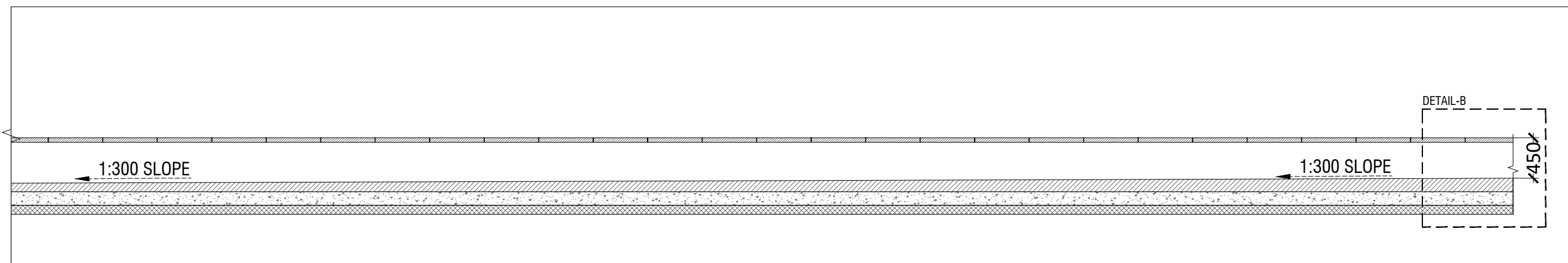
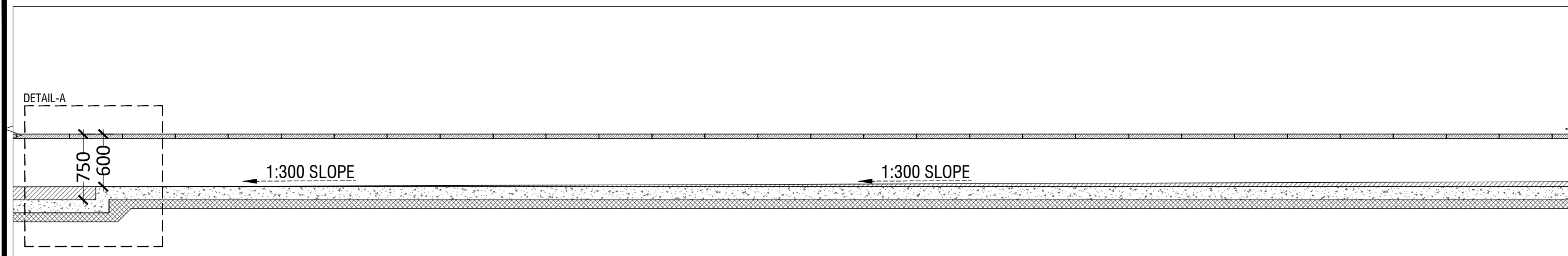

1 TYPICAL DRAIN SLOP SECTION  
1:50

2 TYPICAL DRAIN SLOP SECTION  
1:50

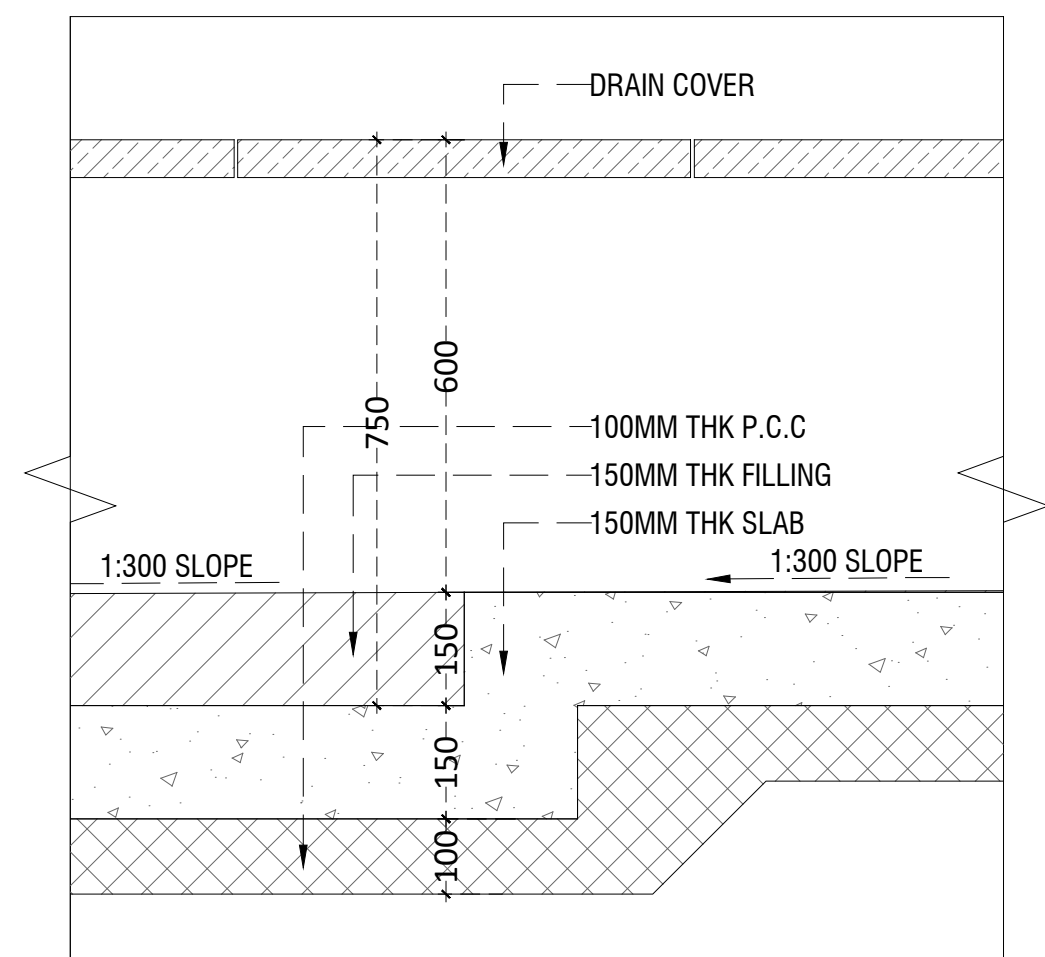

3 TYPICAL DETAIL-A  
1:10

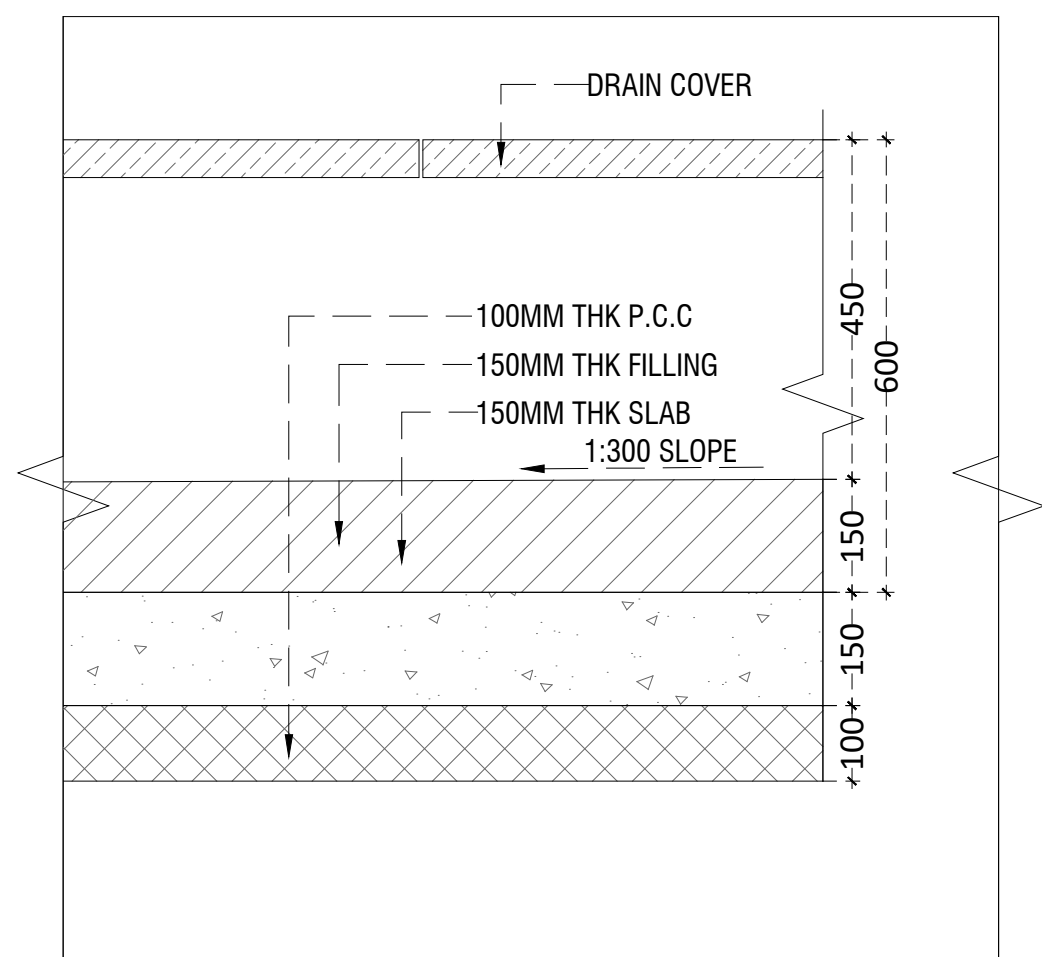

4 TYPICAL DETAIL-B  
1:10

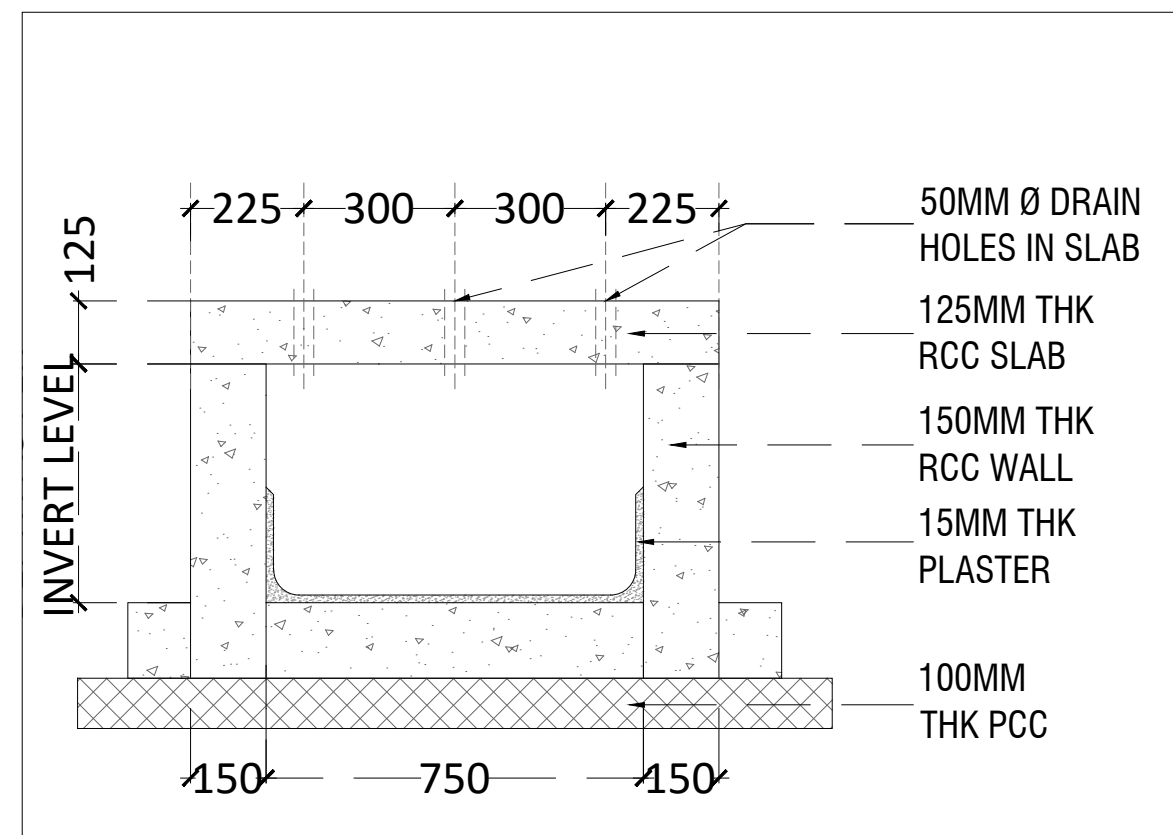

5 TYPICAL BOX DRAIN DETAIL SECTION-1  
1:20

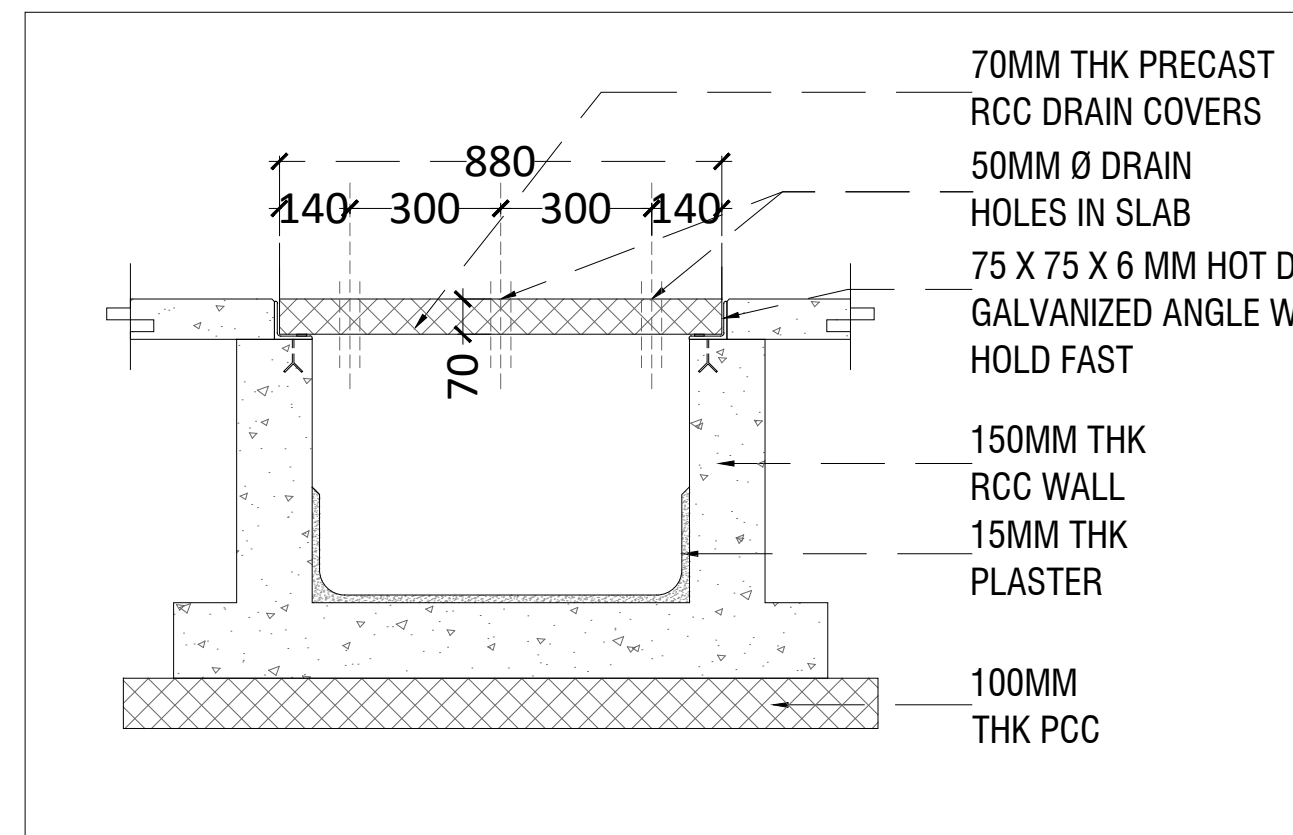

6 TYPICAL RCC DRAIN COVER DETAIL SECTION-2  
1:20

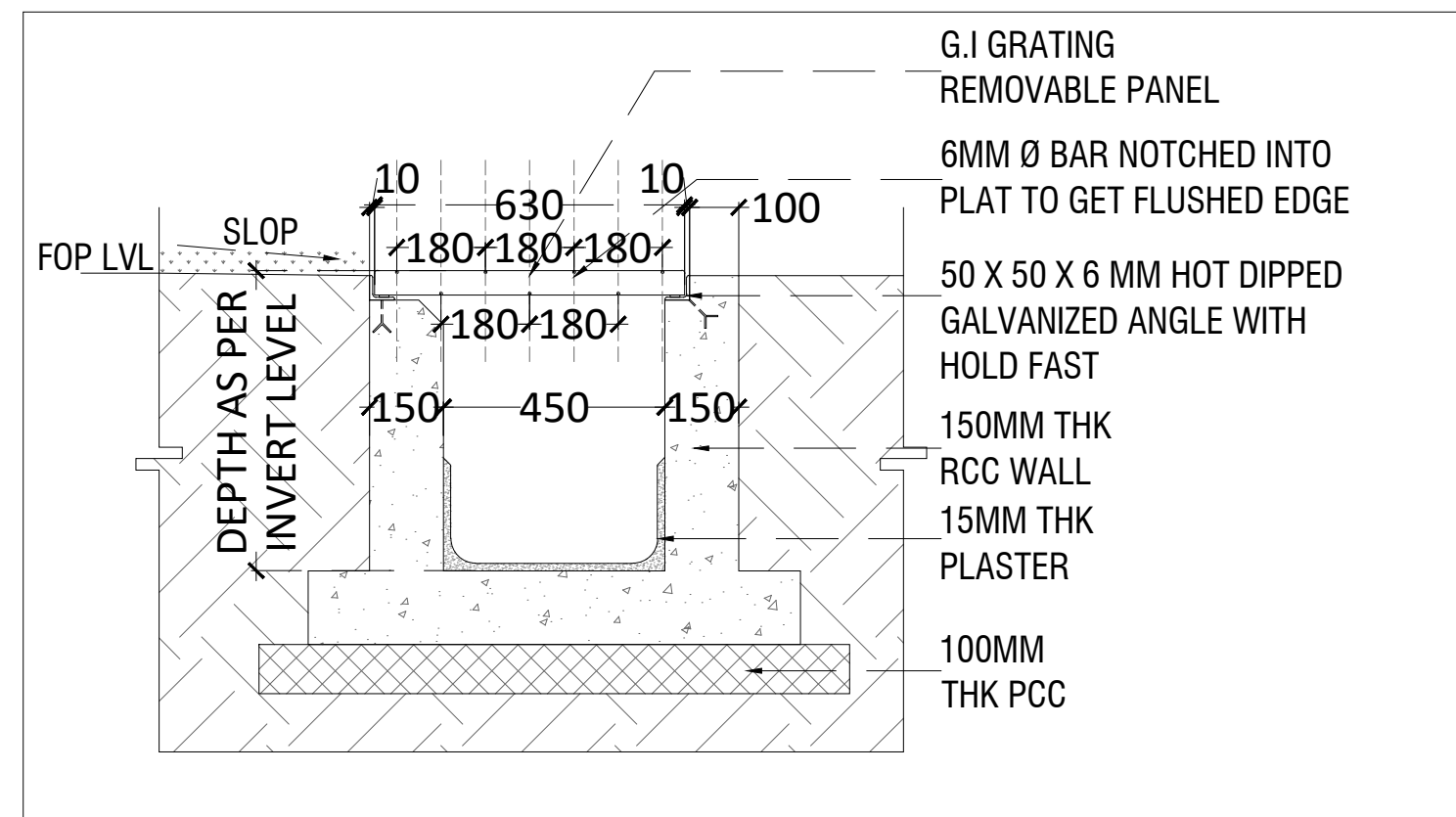

6 TYPICAL GRATING DRAIN COVER DETAIL SECTION-3  
1:20

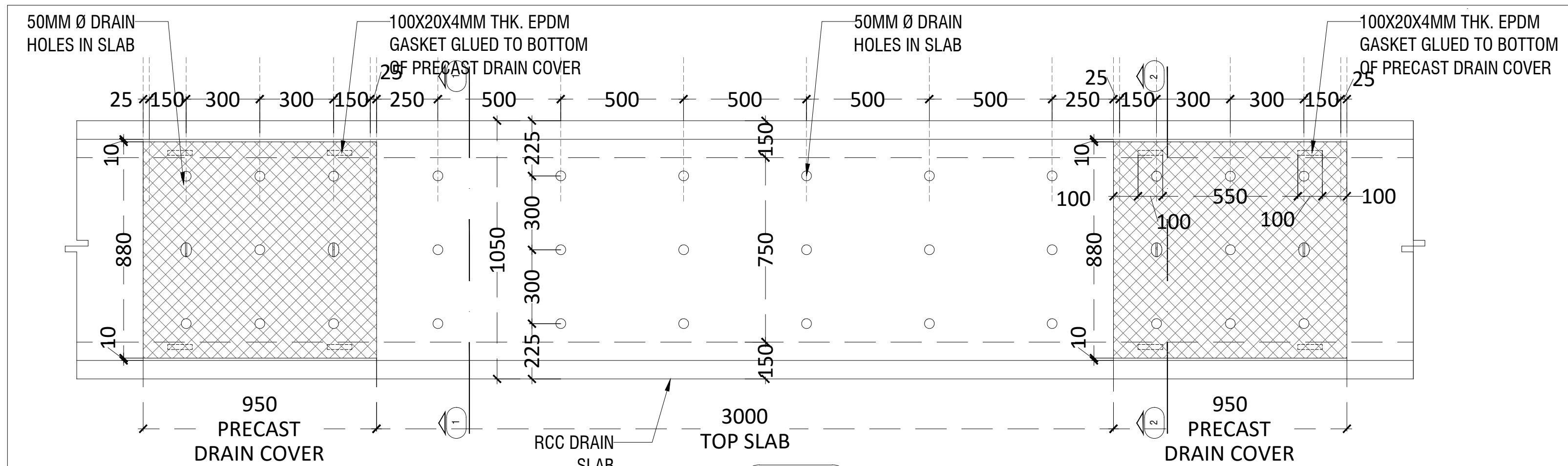

8 TYPICAL RCC DRAIN COVER DETAIL PLAN  
1:20

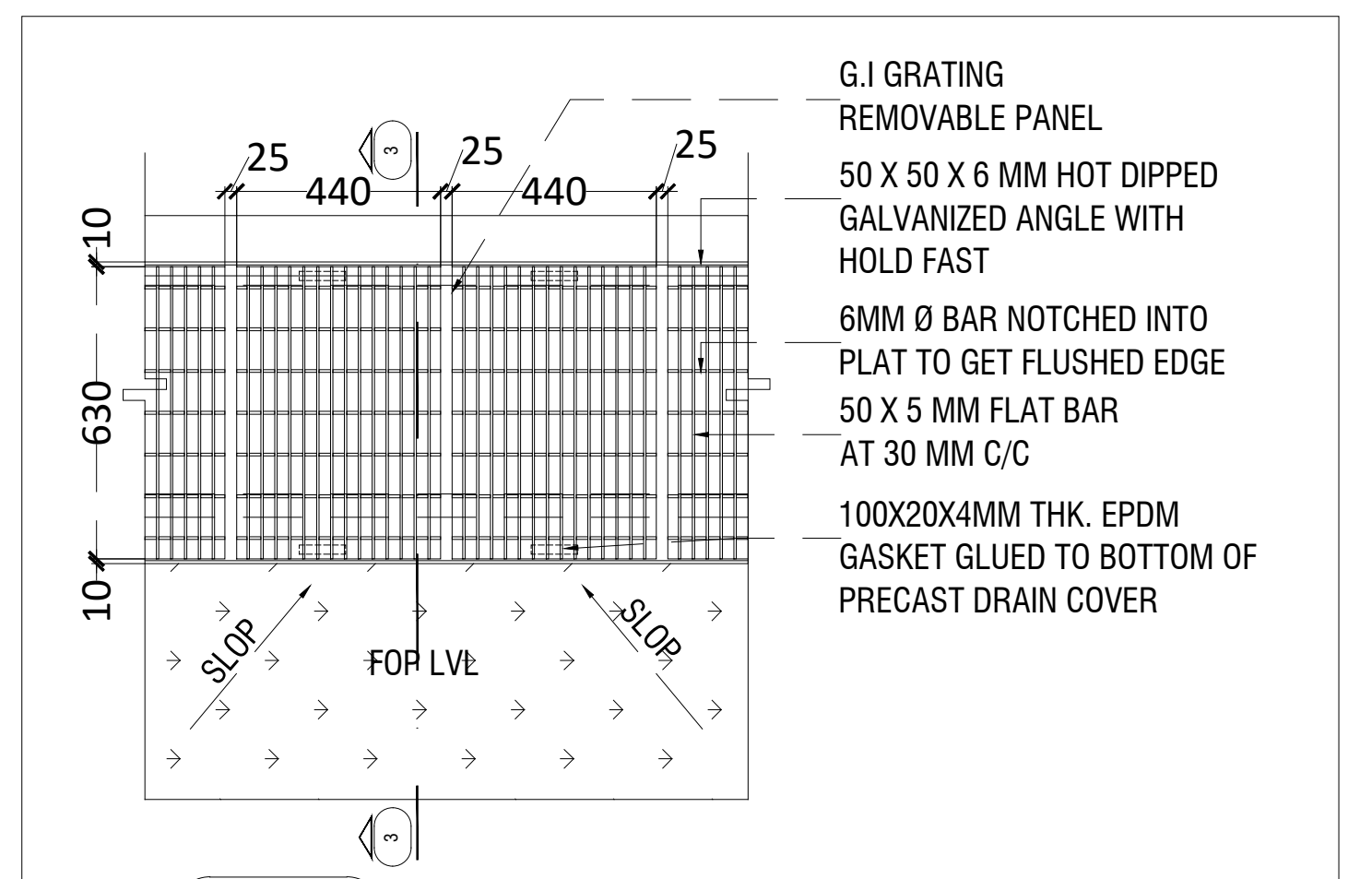

8 TYPICAL GRATING DRAIN COVER DETAIL PLAN  
1:20

## CLIENT

**ALL INDIA FOOTBALL FEDERATION**  
Football House, Sector 19, Phase 1,  
Dwarka, New Delhi: 110075  
Tel- 91-11-25308200/ 201  
Fax- 91-11-25308234/ 25308236  
Email- aiff@the-aiff.com

## ARCHITECT

**collage design**  
COLLAGE DESIGN PVT. LTD  
300, Sai Sampanna, Station Rd  
Vikhroli East, Mumbai 400 083  
+91 22 2574 0842 / 43 / 44 / 45  
www.collagedesign.net

## STRUCTURAL CONSULTANT

**Shanghvi and Associates Consultants Pvt.Ltd.**  
7th Floor, PadmaVati Heights,  
Shradhdhanand Road, Vile Parle (E),  
Mumbai - 400057.  
Tel - +91 22 2614 4832, Fax - +91 22 2617 1804

## PROJECT

NATIONAL CENTRE OF EXCELLENCE  
IN FOOTBALL @ RAJRAHAT, KOLKATA

## DRAWING TITLE

**TYPICAL ROAD & DRAIN SECTION  
SHEET-4**

DWG. NO.	REV. NO.
TD-A.0.04D	R0
PROJECT NO.	18-P245
SCALE	AS SHOWN
1 <sup>st</sup> ISSUED ON	19-02-2019
APPROVED	RS
CHECKED BY	
DRAWN BY	BD



# TENDER DRAWING

## GENERAL NOTES

1. ALL DIMENSIONS ARE IN MILLIMETERS AND LEVELS ARE IN METER UNLESS OTHERWISE SPECIFIED.
2. ALL DIMENSIONS ARE TO BE CHECKED AND CO-RELATED WITH THE RELEVANT ARCHITECTURAL, STRUCTURAL AND SERVICES DRAWINGS AND ANY AMBIGUITY, DISCREPANCY OR OMISSION SHALL BE BROUGHT IN TO NOTICE OF ARCHITECT PRIOR TO COMMENCEMENT OF EXECUTION.
3. DO NOT SCALE THE DRAWING, WRITTEN DIMENSION TO BE FOLLOWED.
4. THIS DRAWING TO BE READ IN CONJUNCTION WITH THE RELEVANT SERVICES AND STRUCTURAL DRAWINGS.

## REVISIONS

REV	DESCRIPTION	DATE

## KEY PLAN

## CLIENT



**ALL INDIA FOOTBALL FEDERATION**  
Football House, Sector 19, Phase 1,  
Dwarka, New Delhi: 110075  
Tel- 91-11-25308200/ 201  
Fax- 91-11-25308234/ 25308236  
Email- aiff@the-aiff.com

## ARCHITECT



**COLLAGE DESIGN PVT. LTD.**  
300, Sai Sampanna, Station Rd  
Vikhroli East, Mumbai 400 083  
+91 22 2574 0842 / 43 / 44 / 45  
www.collagedesign.net

## STRUCTURAL CONSULTANT



**Shanghvi and Associates  
Consultants Pvt.Ltd.**  
7th Floor, Padmavati Heights,  
Shradhdhanand Road,Vile Parle (E),  
Mumbai - 400057.  
Tel - +91 22 2614 4832, Fax - +91  
22 2617 1804

## PROJECT

NATIONAL CENTRE OF EXCELLENCE  
IN FOOTBALL @ RAJRAHAT, KOLKATA

## DRAWING TITLE STRUCTURAL DRAIN DETAILS

DWG. NO.	REV. NO.
TD-S.4.03C	RO
PROJECT NO. 18-P245	
SCALE NTS	
1 <sup>st</sup> ISSUED ON 19-02-2019	
APPROVED	
CHECKED BY	
DRAWN BY	

## DRAIN SECTION WITHOUT VEHICULAR MOVEMENT

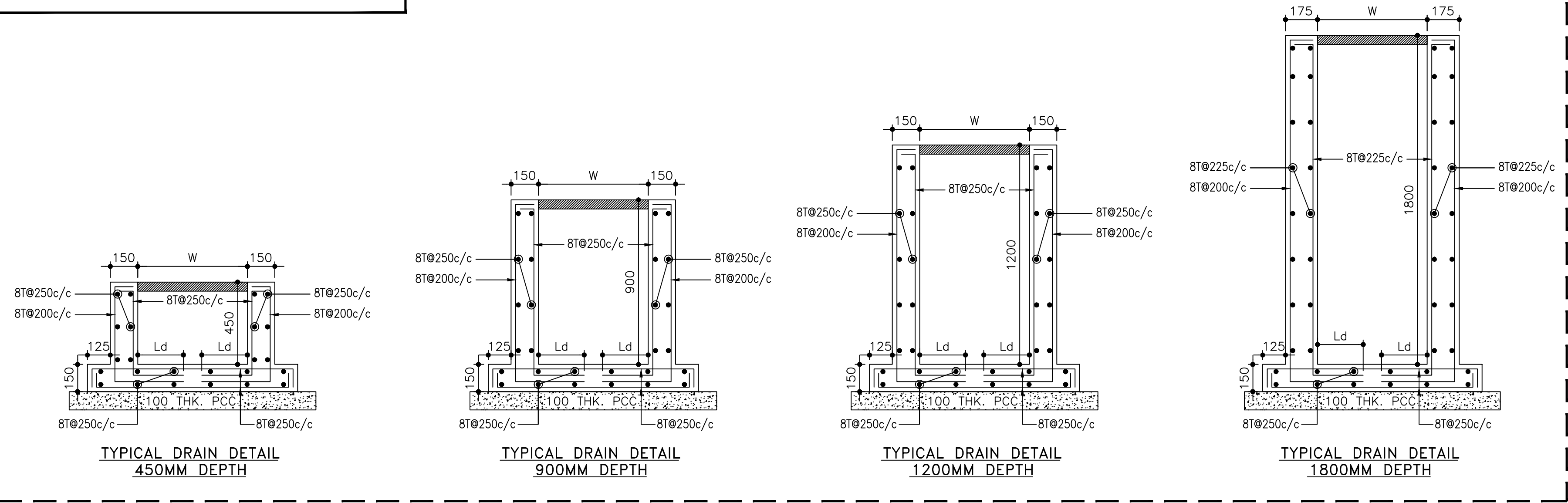

## DRAIN SECTION WITH VEHICULAR MOVEMENT

